

# Filler Power Base

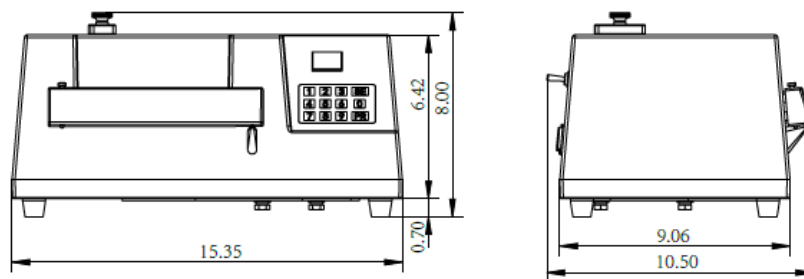
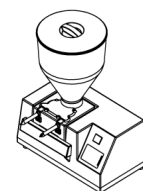

Fig. A



## Operating Instructions

The filler power base requires a filler unit. The filler unit is placed on top of the filler power base. Before operating the filler power base, make sure the filler unit is placed on the base as seen in Fig. A.

1. Attach the power cord to the back side of the power base and plug the cord into a grounded electrical outlet and switch the power on. The switch is located on the back side of the power base.
2. Place the product into the filler unit. For consistent operation, make sure the product is free from lumps and air pockets.
3. To set an amount to be dispensed, enter a two-digit number from 01 to 99. The amount can be changed by keying in a new number.
4. To begin dispensing, press the trip arm located on the front of the power base. A slight reverse motion has been programmed to help eliminate dripping.

### **WARNING:**

**DO NOT PLACE FILLER POWER BASE IN WATER OR ANY LIQUID**  
**DO NOT SPRAY FILLER POWER BASE WITH WATER**  
**DO NOT CLEAN THE FILLER POWER BASE WITH CHEMICALS**

## Cleaning Instructions for Filler Power Base

To clean the filler power base, first, unplug the cord from the electrical outlet and then, clean the exterior using a damp cloth only.

# Filler Power Base

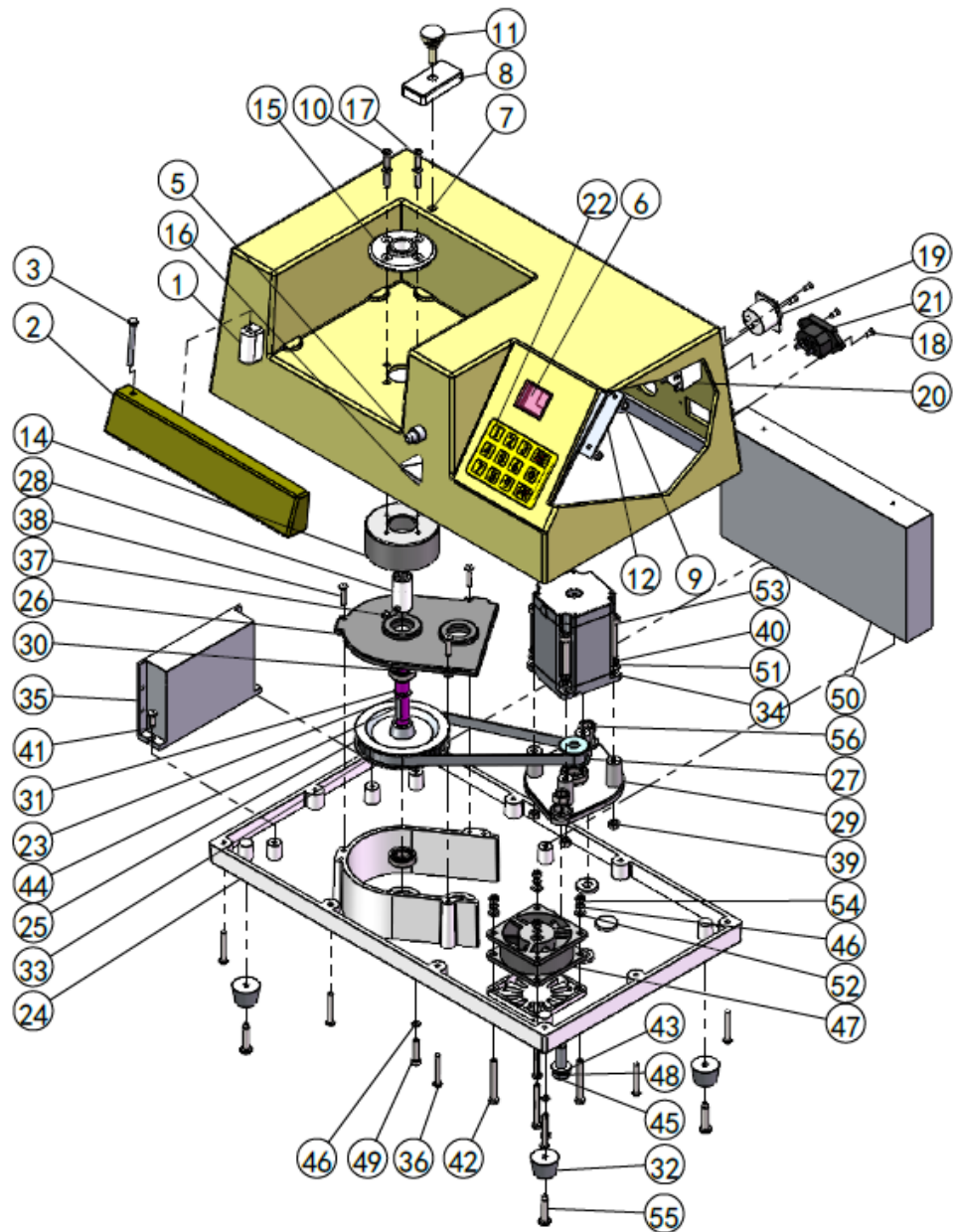

# Filler Power Base

Item #	Description	Qty	Item #	Description	Qty
1	Pin Seat	1	29	Motor Base	1
2	Trip Arm	1	30	Bearing	3
3	Trip Arm Pin	1	31	Clip	1
4	Circuit Board Retainer (not shown)	1	32	Rubber Foot	4
5	Trip Arm Switch	1	33	Belt	1
6	Display Window	1	34	Motor	1
7	Nut	1	35	Driver	1
8	Pump Safety Clamp	1	36	Screw	10
9	Screw	4	37	Screw	1
10	Screw	4	38	Screw	3
11	Screw	1	39	Nut	4
12	Circuit Board	1	40	Washer	4
13	Base Bar Screw (not shown)	1	41	Screw	2
14	Rotary Base Flange	1	42	Bolt	4
15	Drive Flange	1	43	Screw	2
16	Trip Arm Support	1	44	Key	1
17	Power Base Housing	1	45	Bolt	2
18	Screw	4	46	Washer	6
19	Foot Switch Socket	1	47	Fan	1
20	Switch	1	48	Washer	2
21	Power Cord Socket	1	49	Screw	2
22	Keypad	1	50	Power Supply	1
23	Shaft	1	51	Washer	4
24	Base Frame	1	52	Screw	4
25	Wheel	1	53	Screw	4
26	Cover	1	54	Nut	4
27	Pulley	1	55	Screw	4
28	Sleeve	1	56	Nut	2